



The San Luis Hotel

STAY: Each of the 250 guest rooms at The San Luis Hotel features a balcony overlooking the Gulf, residentially-appointed features and sumptuous bed and bath amenities. The executive Club Ten, an adults-only level on the tenth floor, offers added comforts like complimentary champagne, breakfast on the floor, express check-in and private elevator access.

MEET: The San Luis Hotel houses 40,000 square feet of IACC-approved conference center space, recently updated and expertly appointed.

PLAY: The San Luis Hotel's H2o Pool + Bar is a tropical island escape, featuring a swim-up bar, an impressive waterslide, waterfalls, poolside service and rentable cabanas, complete with lounge furniture, satellite TV, mini fridge and microwave.

DINE: Savor the world-famous Steakhouse, recognized by food critic Tom Horan as the No. 1 steakhouse in Texas. Grotto, reminiscent of an old-world trattoria, serves extraordinary Italian cuisine or enjoy a quick salad or sandwich from Blake's Bistro, a family-friendly bistro and lounge overlooking the pool.

RELAX: Unwind at the lavish Spa San Luis, voted No. 1 in Galveston. A full menu of spa and salon services, manicures and pedicures, therapeutic massages, invigorating facials and hydrotherapy baths provide perfect pampering on the Island.

53rd & Seawall Boulevard, Galveston Island, Texas 77551
Phone: (409) 740-8617 • Fax: (409) 744-7545 • sanluisresort.com

THE SAN LUIS *Hotel*

SPA & CONFERENCE CENTER

MAIN LOBBY - Third Floor

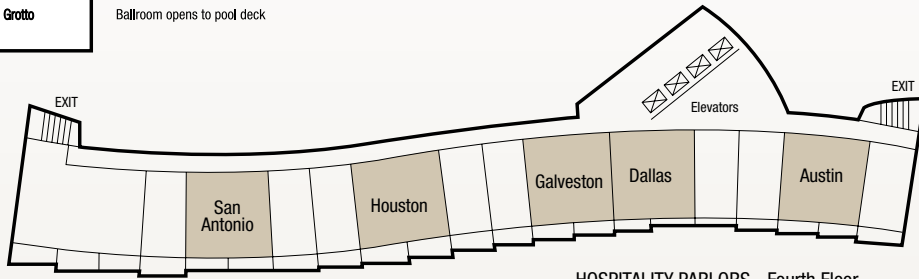
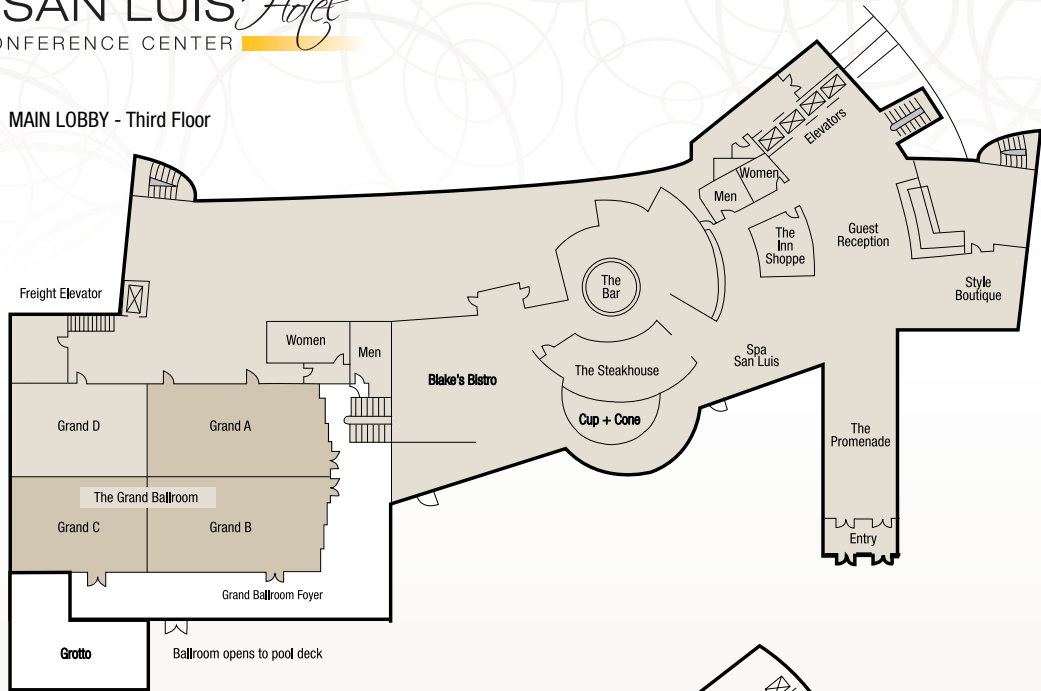

HOSPITALITY PARLORS - Fourth Floor

	DIMENSIONS	CEILING HEIGHT	SQUARE FEET	BANQUET	RECEPTION	THEATRE	CLASSROOM	U-SHAPE	HOLLOW SQUARE
MAIN LOBBY — THIRD FLOOR									
Grand Ballroom	60' x 100'	14'	6,000	550	650	650	400	-	-
Grand A	26' x 57'	14'	1,482	120	175	160	70	40	60
Grand B	34' x 57'	14'	1,938	160	205	200	130	40	50
Grand C	34' x 39'	14'	1,326	110	140	150	80	40	60
Grand D	26' x 39'	14'	1,014	80	110	100	60	40	60
Grand A & B	60' x 57'	14'	3,420	260	360	350	200	100	-
Grand C & D	39' x 60'	14'	2,340	190	250	250	120	70	80
Grand A & D	26' x 100'	14'	2,600	200	274	255	120	-	-
Grand B & C	34' x 100'	14'	3,400	280	360	350	200	-	-
HOSPITALITY PARLORS — FOURTH FLOOR									
Hospitality Parlors	-	8'	750	40	-	-	-	10	42

Notes

CONFERENCE CENTER - First Floor

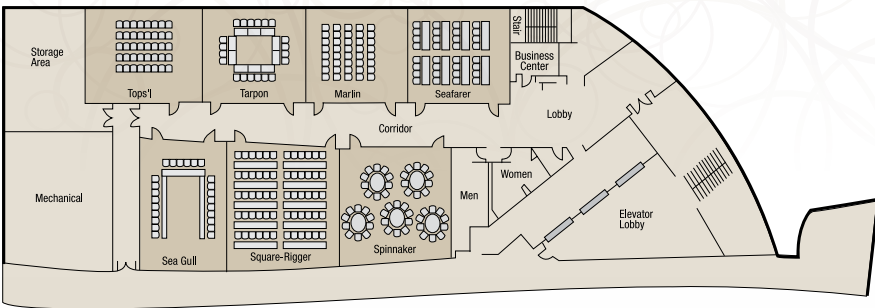

CONFERENCE CENTER - Second Floor

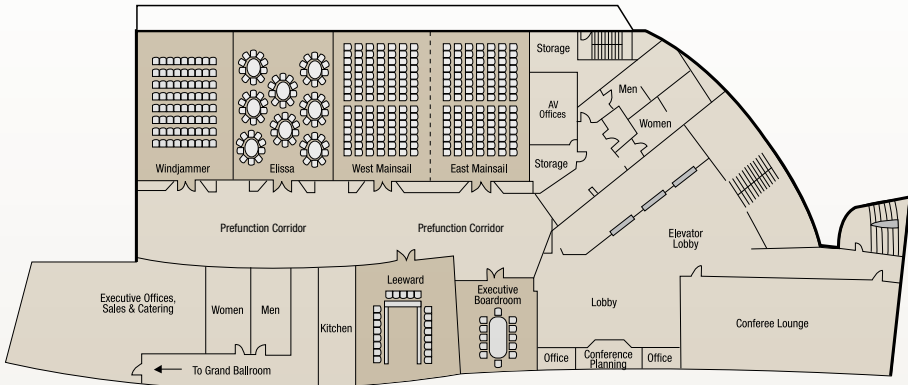

	DIMENSIONS	CEILING HEIGHT	SQUARE FEET	BANQUET	RECEPTION	THEATRE	CLASSROOM	CONFERENCE	U-SHAPE	HOLLOW SQUARE
CONFERENCE CENTER — FIRST FLOOR										
Tarpon	30' x 24'	10'	720	56	74	77	48	20	16	20
Marlin	30' x 24'	10'	720	56	74	77	48	20	16	20
Seafarer	30' x 24'	10'	720	56	74	77	48	20	16	20
Sea Gull	25' x 36'	10'	900	72	95	100	60	20	16	20
Square-Rigger	34' x 34'	10'	1,156	90	121	127	78	20	22	30
Spinnaker	32' x 31'	10'	1,020	80	105	111	69	20	20	24
Tops'l	35' x 24'	10'	840	64	89	94	57	20	16	20
CONFERENCE CENTER — SECOND FLOOR										
Windjammer	34' x 46'	12'	1,564	128	163	172	105	-	36	42
Elissa	34' x 46'	12'	1,564	128	163	172	105	-	36	42
West Mainsail	34' x 46'	14'	1,564	128	163	172	105	-	36	42
East Mainsail	34' x 46'	14'	1,564	128	163	172	105	-	36	42
East & West Mainsail	68' x 46'	14'	3,128	256	326	344	213	-	-	-
Leeward	27' x 29'	9'	783	60	79	83	51	-	14	18
Executive Boardroom	27' x 27'	9'	729	-	-	-	-	14	-	-
Prefunction Corridor	28' x 132'	9'	3,696	-	389	-	-	-	-	-

Notes _____
